

# ARTOME S2



## General specs

Name	Artome S2
Materials	Birch plywood, MDF, steel, aluminum, polyester fabric
Dimensions	(W x H x D) 20.5" x 33.9" x 19.1" / 52.1 cm x 86.1 cm x 48.5 cm
Frame colour	White
Door colour options	Black (Default), Nevada, Walnut
Weight (excl. projector)	88 lb / 40 kg
Warranty	24 months (option to extend up to 60 months)

## Technical specs

Power inlet	100-240V ~ 50/60HZ 5A (Fused)
Power outlet	100-240V ~ 50/60Hz, 2A (240W @ 120V)
Power consumption (excl. projector)	75W (0.63A @ 120V)
Sound	2.1-speaker system. Max. SPL 99 dB @ 3.28ft
Operating temperature	32-86 °F / 0-30 °C
19" rack	3U x 11" (depth)
Controls	Power, Source, Vol +/-, Pause, Freeze, Mic gain
Bluetooth Remote	Yes
Artome Connect App Compatible	Yes
Automatic Projector Provisioning	Yes

## Connections

Front panel	1 x HDMI, 1 x USB-B, 2 x XLR Mic in with Level Control 2 x XLR out, 1 x USB-A, Power outlet (100-240V~ 50/60Hz)
Top panel	1 x USB-A (Webcam Connection)
Back panel	1 x HDMI, 1 x Audio in 3,5 mm, 2 x Customizable passthrough slots for D-type connectors
Projector	All unused connectors can be accessed

## Projector specs

Compatible projectors	Epson Powerlite 760W/770F/775F
Brightness	4000-4100 lm
Power consumption	267W (2.25A @ 120V)
Resolution	760W WXGA, 770/775F Full HD
Recommended image size	60-150"
Weight	13 lb / 5.9 kg



\*The Purchaser needs to activate the five (5) year warranty within six (6) months from purchase by registering the product in [www.artomeinstaller.com](http://www.artomeinstaller.com).

# ARTOME S2



1x USB-A (5V=1A)  
(Webcam Connection)

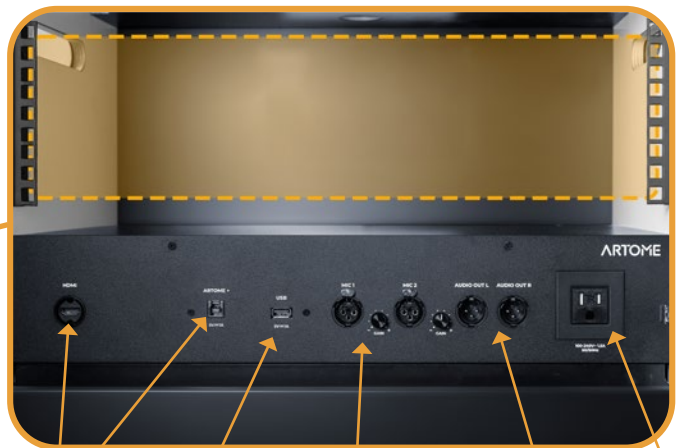

HDMI & USB-B    USB-A (5V=1A)    Mic 1 & 2 XLR (Mic or Line in option)    Audio Out XLR    Power Outlet

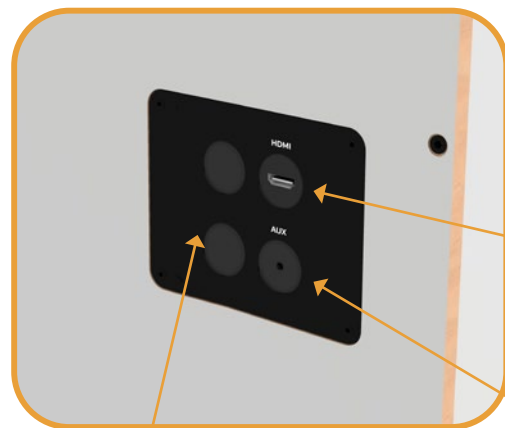

HDMI

3,5mm Audio in

2 x customizable passthrough slots for D-type connectors